



# MX Estimation

---

**Claim Number:**

**Policy Number:**

**Type of Loss:**

Date of Loss:

Date Received:

Date Inspected:

Date Entered: 2/4/2026 7:48 PM

Price List: CASD8X\_02MAY26  
Restoration/Service/Remodel  
Estimate: 4486146V21

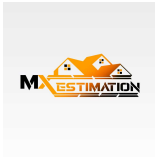

**4486146V21**

**1st Floor**

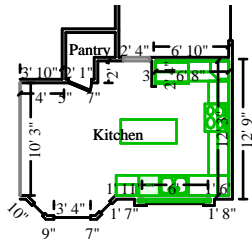

**Kitchen**

**Height: 8'**

372.47 SF Walls	229.11 SF Ceiling
601.58 SF Walls & Ceiling	229.11 SF Floor
25.46 SY Flooring	48.02 LF Floor Perimeter
58.44 LF Ceil. Perimeter	

<b>Window</b>	<b>1' 4" X 4' 8"</b>	<b>Opens into Exterior</b>
<b>Window</b>	<b>3' 4" X 4' 8"</b>	<b>Opens into Exterior</b>
<b>Window</b>	<b>1' 4" X 4' 8"</b>	<b>Opens into Exterior</b>
<b>Missing Wall - Goes to Floor</b>	<b>2' 4" X 6' 5"</b>	<b>Opens into FORMAL_DININ</b>
<b>Door</b>	<b>2' 1" X 6' 6"</b>	<b>Opens into PANTRY</b>
<b>Missing Wall</b>	<b>10' 3" X 8'</b>	<b>Opens into Exterior</b>

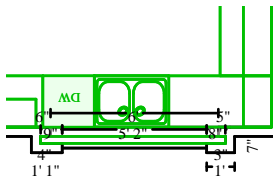

**Subroom: Kitchen (1)**

**Height: 6' 6"**

34.25 SF Walls	1.65 SF Ceiling
35.90 SF Walls & Ceiling	1.65 SF Floor
0.18 SY Flooring	7.71 LF Floor Perimeter
13.71 LF Ceil. Perimeter	

<b>Missing Wall - Goes to Floor</b>	<b>6' X 6' 5"</b>	<b>Opens into KITCHEN</b>
<b>Window</b>	<b>5' 2" X 3' 2"</b>	<b>Opens into Exterior</b>

DESCRIPTION	QTY	REMOVE	REPLACE	TAX	TOTAL
1. Water Extraction & Remediation Technician - per hour	32.00 HR	0.00	80.00	0.00	2,560.00
2. Eye protection - plastic goggles - Disposable	2.00 EA	0.00	10.26	1.59	22.11
3. Personal protective gloves - Disposable (per pair)	2.00 EA	0.00	0.39	0.06	0.84
4. Personal protective mask (N-95)	2.00 EA	0.00	1.57	0.24	3.38
5. Dehumidifier (per 24 hr period) - 70-109 ppd - No monitor.	10.00 EA	0.00	87.67	0.00	876.70
6. Air mover (per 24 hour period) - No monitoring	20.00 EA	0.00	30.10	0.00	602.00
7. Negative air fan/Air scrubber (24 hr period) - No monit.	2.00 DA	0.00	80.57	0.00	161.14
8. Containment Barrier/Airlock/Decon. Chamber	160.00 SF	0.00	1.24	2.11	200.51
9. Peel & seal zipper	1.00 EA	0.00	15.34	0.78	16.12



**MX Estimation**

**CONTINUED - Kitchen**

DESCRIPTION	QTY	REMOVE	REPLACE	TAX	TOTAL
10. Containment Barrier - tension post (per day)	10.00 DA	0.00	3.35	0.00	33.50
11. Protect - Cover with plastic	230.70 SF	0.00	0.47	2.32	110.75
12. Floor protection - cardboard and tape	230.70 SF	0.66	0.00	5.01	157.27
13. Floor protection - plastic and tape - 10 mil	100.00 SF	0.00	0.41	0.93	41.93
14. Tear out wet drywall, cleanup, bag for disposal	76.00 SF	1.36	0.00	0.88	104.24
15. Tear out and bag wet insulation	65.00 SF	1.01	0.00	0.30	65.95
16. Tear out cabinetry - upper (wall) units	6.00 LF	13.26	0.00	0.00	79.56
17. Tear out cabinetry - lower (base) units	10.00 LF	13.26	0.00	0.00	132.60
18. Cabinet - lower (base) unit w/shoring - Detach	10.00 LF	0.00	45.20	2.52	454.52
19. Tear out countertop - solid surface/granite	15.00 SF	7.61	0.00	0.00	114.15
20. HEPA Vacuuming - Detailed - (PER SF)	45.00 SF	0.00	1.23	0.00	55.35
21. Clean stud wall	45.00 SF	0.00	1.26	0.07	56.77
22. Dishwasher - Detach & reset	1.00 EA	0.00	327.01	0.00	327.01
23. Built-in oven - Detach & reset	1.00 EA	0.00	306.70	0.00	306.70
24. Haul debris - per pickup truck load - including dump fees	1.00 EA	232.71	0.00	0.00	232.71

Totals: Kitchen 16.81 6,715.81

Total: 1st Floor 16.81 6,715.81

**Labor Minimums Applied**

DESCRIPTION	QTY	REMOVE	REPLACE	TAX	TOTAL
25. Hazardous waste/mold rem. labor min	1.00 EA	0.00	115.15	0.00	115.15
26. Painting labor minimum	1.00 EA	0.00	271.31	0.00	271.31
27. Cleaning labor minimum	1.00 EA	0.00	115.46	0.00	115.46
28. Plumbing labor minimum	1.00 EA	0.00	64.92	0.00	64.92
29. Electrical labor minimum	1.00 EA	0.00	50.96	0.00	50.96

Totals: Labor Minimums Applied 0.00 617.80

Line Item Totals: 4486146V21 16.81 7,333.61



# MX Estimation

Additional Charges	Charge
California Lumber Assessment Fee	0.29
<b>Additional Charges Total</b>	<b>\$0.29</b>

## Grand Total Areas:

1,300.42 SF Walls	601.03 SF Ceiling	1,901.45 SF Walls and Ceiling
572.07 SF Floor	63.56 SY Flooring	134.31 LF Floor Perimeter
0.00 SF Long Wall	0.00 SF Short Wall	170.35 LF Ceil. Perimeter
572.07 Floor Area	619.28 Total Area	1,340.42 Interior Wall Area
1,029.99 Exterior Wall Area	124.19 Exterior Perimeter of Walls	
0.00 Surface Area	0.00 Number of Squares	0.00 Total Perimeter Length
0.00 Total Ridge Length	0.00 Total Hip Length	



**Summary for Dwelling**

Line Item Total	7,316.80
California Lumber Assessment Fee	0.29
Material Sales Tax	16.81
<b>Replacement Cost Value</b>	<b>\$7,333.90</b>
<b>Net Claim</b>	<b>\$7,333.90</b>

---



**Recap of Taxes**

	<b>Material Sales Tax (7.75%)</b>	<b>Storage Rental Tax (7.75%)</b>
<b>Line Items</b>	16.81	0.00
<b>Additional Charges</b>	0.00	0.00
<b>Total</b>	<b>16.81</b>	<b>0.00</b>



**Recap by Room**

**Estimate: 4486146V21**

**Area: 1st Floor**

**Kitchen**

**6,699.00 91.56%**

---

**Area Subtotal: 1st Floor**

**6,699.00 91.56%**

**Labor Minimums Applied**

**617.80 8.44%**

---

**Subtotal of Areas**

**7,316.80 100.00%**

---

**Total**

**7,316.80 100.00%**



**Recap by Category**

<b>Items</b>	<b>Total</b>	<b>%</b>
<b>APPLIANCES</b>	<b>633.71</b>	<b>8.64%</b>
<b>CLEANING</b>	<b>172.16</b>	<b>2.35%</b>
<b>GENERAL DEMOLITION</b>	<b>880.29</b>	<b>12.00%</b>
<b>ELECTRICAL</b>	<b>50.96</b>	<b>0.69%</b>
<b>HAZARDOUS MATERIAL REMEDIATION</b>	<b>312.43</b>	<b>4.26%</b>
<b>PLUMBING</b>	<b>64.92</b>	<b>0.89%</b>
<b>PAINTING</b>	<b>312.31</b>	<b>4.26%</b>
<b>WATER EXTRACTION &amp; REMEDIATION</b>	<b>4,890.02</b>	<b>66.68%</b>
<b>Subtotal</b>	<b>7,316.80</b>	<b>99.77%</b>
<b>Permits and Fees</b>	<b>0.29</b>	<b>0.00%</b>
<b>Material Sales Tax</b>	<b>16.81</b>	<b>0.23%</b>
<b>Total</b>	<b>7,333.90</b>	<b>100.00%</b>

